

DESCRIPTION



Capacity: 4 x 1/1 GN



Trays insertion: Length wise



Dimensions: 523 x 906 x H 667 mm



Control panel: Analogic



Indicative quantity of meals: 48



Cooking chamber heating: Electric



Steam generation: Direct system

COOKING MODES AND FUNCTIONING

	Convection mode	Temperature range between 50 °C and 270 °C
	Steam mode	Temperature range between 50 °C and 100 °C
	Convection-Steam mode	Temperature range between 50 °C and 270 °C
	Reduced fan speed	2 ventilation speed availables
	Autoreverse	Autoreverse device for rotation direction reversal
	Fast cooling	Quick cooling down of the cooking chamber with open door

CONTROL PANEL COMPONENT DESCRIPTION

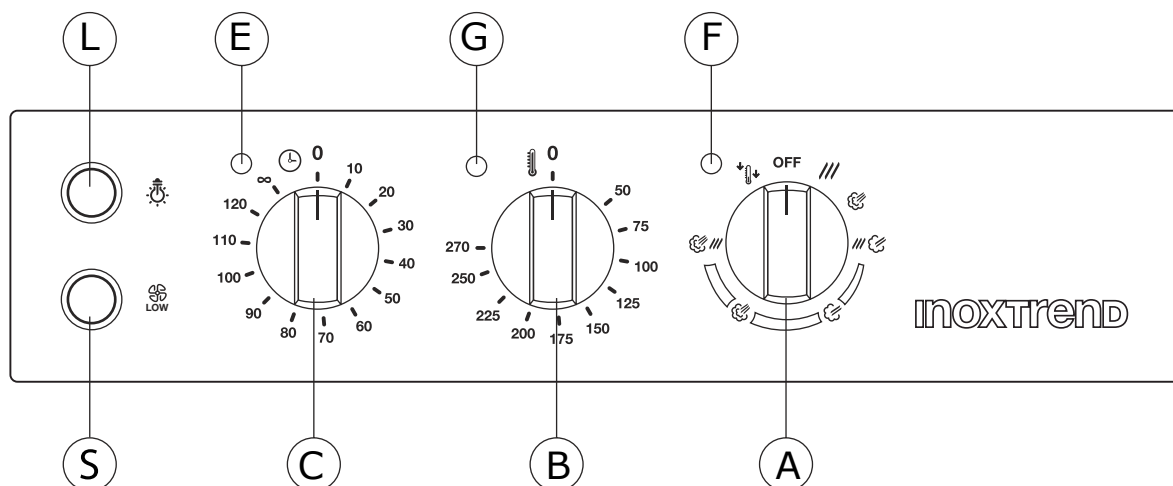

A	Cycle selector-switch
B	Cooking chamber thermostat
C	Timer
E	Timer ON pilot light
F	Oven power supply ON pilot light

G	Heating cooking chamber ON pilot light
L	Cooking chamber light
S	Reduced ventilation speed

MANUFACTURING FEATURES

- Heating system located on the back side of the cooking chamber;
- Waterproof cooking chamber with rounded edges and deflector panels in stainless steel AISI 304;
- Cooking chamber with external welding;
- External covering panels made of satin stainless steel AISI 430;
- Base chassis made of stainless steel AISI 430;
- Door hinges in stainless steel AISI 304;
- Heating element made of stainless steel Incoloy 800;
- Thermal insulation of the cooking chamber in ceramics fibre;
- Tray-holding racks with U-form guides (without welding) entirely built in stainless steel AISI 304;
- Cooking chamber fan made of stainless steel;

- Sense of opening of the door reversible even after installation

OPTIONAL ACCESSORIES

Code	Description
SCR-11-PK8	Stand with shelf
CRG-17-PK7	Tray slides
SCRG-11-PK8	Stand with shelf and tray-slides
FT-31R	Fat filter

Code	Description
DLE	Hand shower
DCF-20	Water softener

DIMENSIONS

	OVEN	PACKAGE
Width	523 mm	600 mm
Depth (with handle)	906 mm	980 mm
Height	667 mm	860 mm
Weight/Volume	81 kg / 0.51 m ³	

WATER SUPPLY

Water supply coupling	Ø ¾" gas
Water pressure	1.5 - 2.5 bar
Water hardness	4 - 12 °f = 40 - 120 ppm
Water conductivity	50 ÷ 2000 µS/cm
Chlorine concentr. Cl₂	< 0.2 mg/litre
Chloride concentration	<150 mg/litre
Water drain coupling	Ø 32 mm

POWER SUPPLY

Model	PK-DA-104E
Power loading	5.2 kW
Chamber power	4.9 kW
Power of the motors	n° 1 x 250 W
Max. power loading	5.2 kW
Voltage	380 - 415 V +3N ~ 50 Hz
Absorbed current	8.5 A
Feed cable section	n° 5 x 1.5 mm ²
Capacity	4 x 1/1 GN
Pitch between trays	67 mm

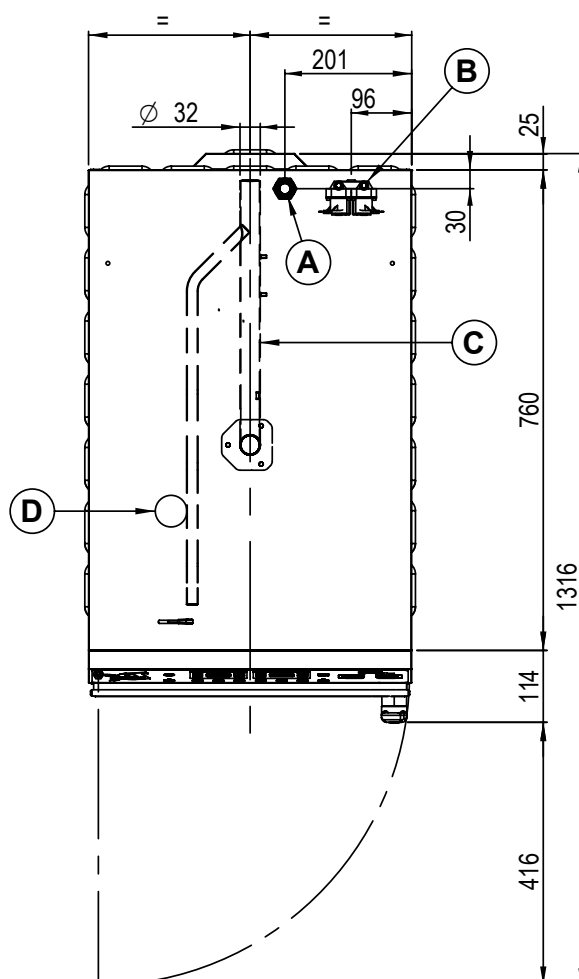
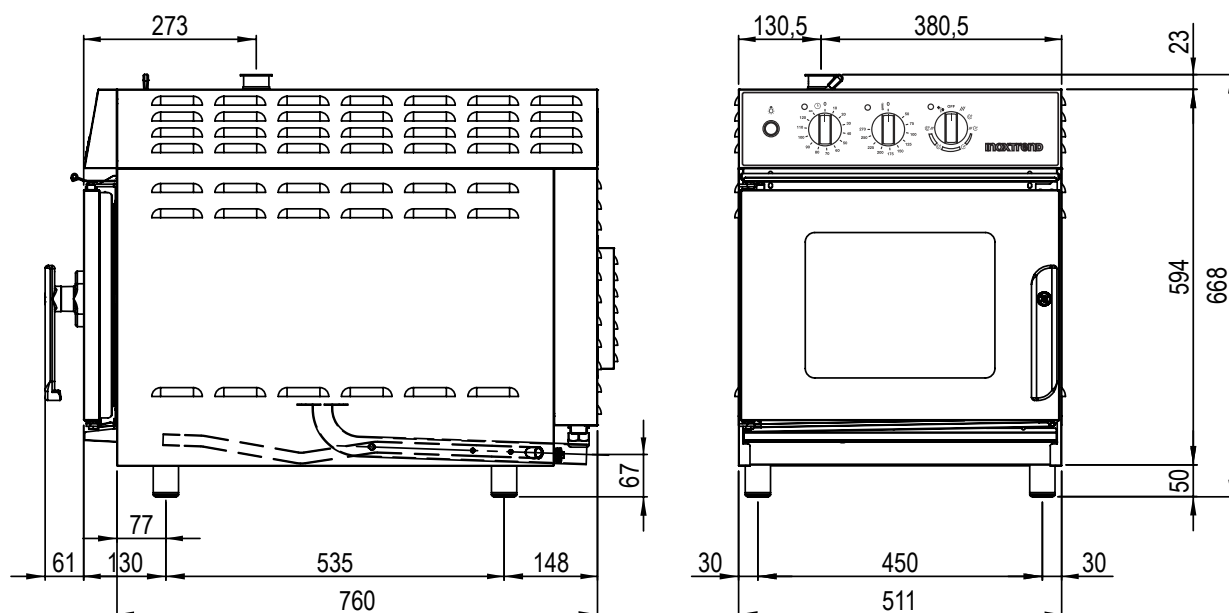

- A Electrical cables connection
- B Water inlet \varnothing 3/4" gas
- C Chamber drainage \varnothing 32 mm
- D Cooking chamber release valve